

CERTIFICATE OF LOCATION OF GOVERNMENT CORNER

NORTHEAST Corner of Section 9, Township 106, Range 42, 5TH P.M.

STATE OF MINNESOTA, County of MURRAY

At the corner location shown on the sketch:

On 5/4/14 found a stone
DATE

left monument as found, lowered monument, removed monument (explain)

On 5/4/14 placed a 5/8" iron w/seal #50343
DATE

SKETCH OF REFERENCE TIES

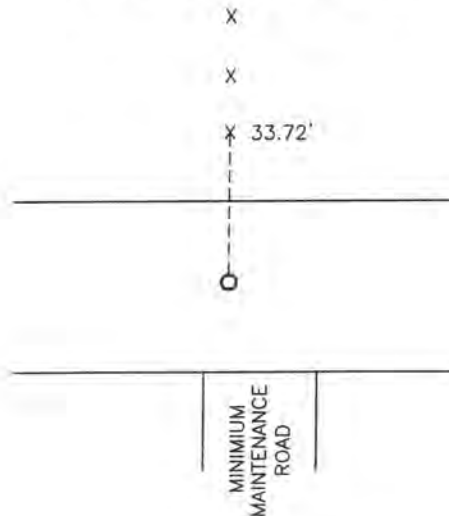

Minnesota State Plane Coordinate
System Murray County Datum
NAD83 (1996)

N: 158265.824
E: 469200.307

Nail and survey marker in wood post North 33.72'

Statement of evidence relative to this corner location is on back of page.

I hereby certify that this document and the data contained herein was prepared by me or under my direct supervision.

[Signature] 1/21/15
SIGNATURE DATE
Registration No. 50343

Land Surveyor, Professional Engineer
 County Surveyor, County Engineer

OFFICE OF THE COUNTY RECORDER

County of _____

I hereby certify that this document was filed in the Co. Recorders office at _____ .M on the _____ day of FEB 20 2015 A.D. 20 _____

County Recorder Evelyn C. Larson

By _____, Deputy

DOCUMENT NO. _____

Statement of Evidence

In 1866, J.W. Bishop did the original subdivision of the township.

On June 25, 1902, J.W. Woolstencroft recorded a 10"x12"x16" stone at the corner.

On May 4, 2014, Bueltel-Moseng Land Surveying dug with a backhoe and found multiple stones that fit the description. We held to the stone that best fits the occupation lines. Set $\frac{5}{8}$ " iron with seal #50343 over found stone at the surface of road. It is in centerline of road and in line with fence to the north.